

Instructions for the BASIC BCBA Mixing/Air intake section, Sizes 080–120

1. General

The BCBA Mixing and air intake section has two interconnected dampers at one level for mixing recirculated air with the outdoor air. The dampers are flow-perpendicular and have counter-rotating damper blades made of aluminium-zinc coated double-skin sheet steel, to environment class M3. The mixing section offers excellent air mixture with linear flow characteristic.

Inspection can be carried out from the adjacent section.

The damper motor can be installed between the dampers at the centre of the mixing section.

The damper blades are journalled in nylon bearings.

The two damper assemblies are individually adjustable for obtaining the appropriate mixing ratio.

The BCBA is available in an air intake variant (installation alternative 4 and 8).

1.1 Specification

The version, size, etc. are specified in the delivery documents.



BCBA

2. Installation

2.1 Mounting

Fit the mixing section with the damper shafts horizontal. The BCBA should be connected to the ducting as follows:

a) With a BCBZ-1-aaa-18 connection frame

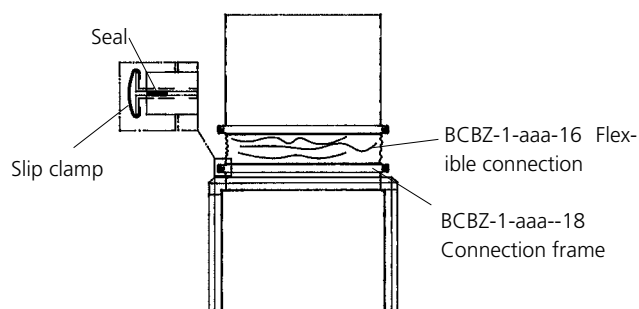

b) With flanged duct

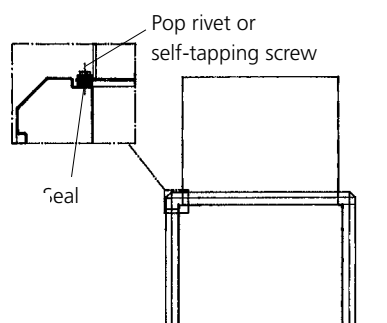

2.2 Installation alternatives

For mounting at the inlet

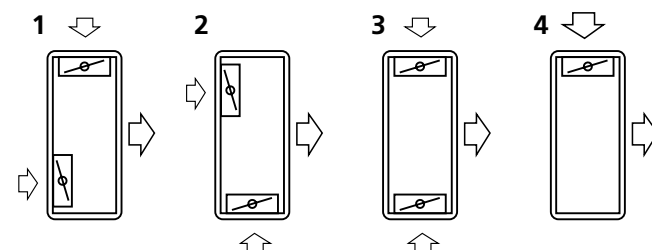

For mounting at the outlet

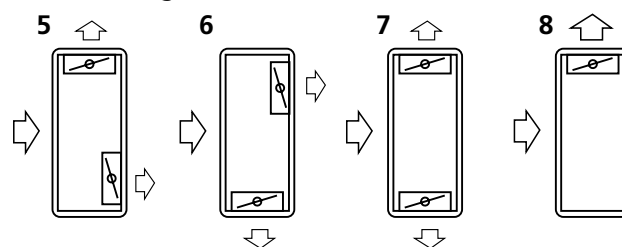

3. Technical data

3.1 Torque

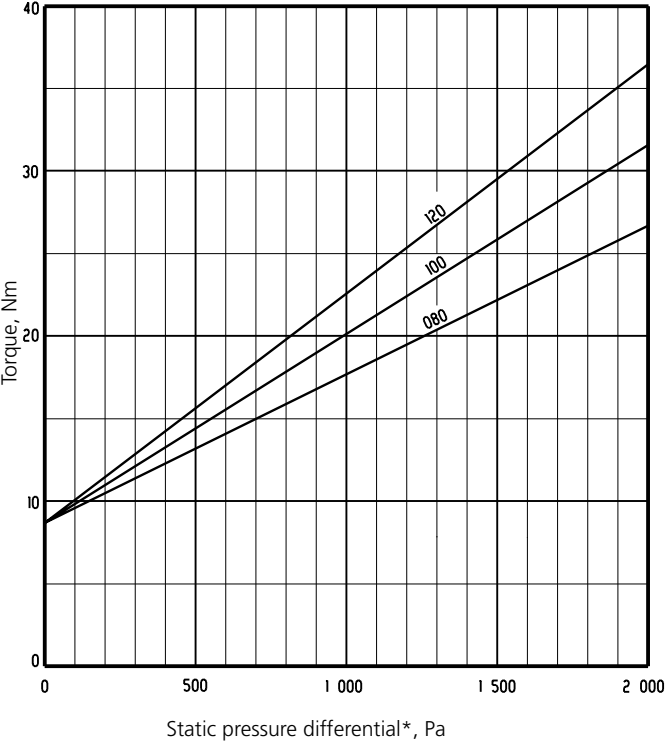

*Pressure differential across closed damper(s).

The size 080–120 sections are equipped with two dampers per opening, a total of four dampers. The two dampers that are in the same opening are interconnected, thus two damper actuators are necessary (one for each opening). The torque has been calculated for two interconnected dampers.

3.2 Dimensions

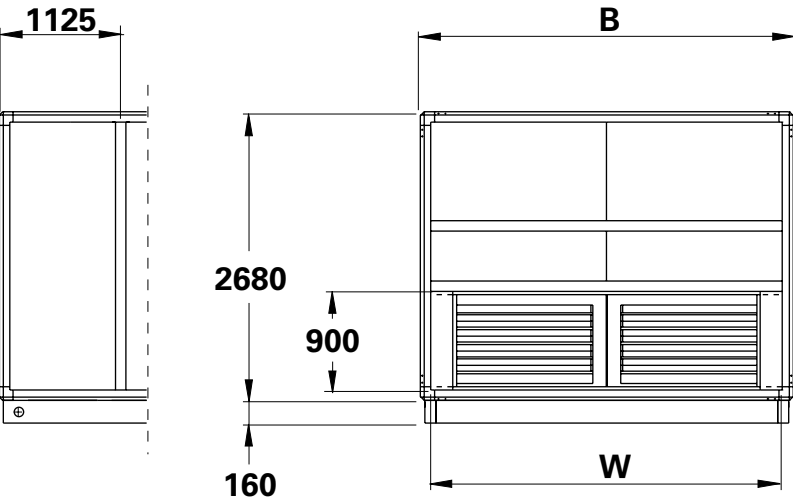

BCBA	B	W	Wgt.
080	2680	2530	500
100	3390	3240	570
120	3940	3790	640

Base beams: Standard