

LOCKZONE Wall

Rectangular perforated wall diffuser



QUICK FACTS

- Guide vane perforations
- Cleanable
- Simple commissioning
- Used together with ALV commissioning box
- Standard colour White RAL 9003
 - 5 alternative standard colours
 - Other colours upon request

AIR FLOW - SOUND PRESSURE ROOM (Lp10A) *)							
LOCKZONE W Size	ALV Size	25 dB(A)		30 dB(A)		35 dB(A)	
		l/s	m³/h	l/s	m³/h	l/s	m³/h
300-150	300-150-100-B	14	50	18	65	33	119
400-150	400-150-125-B	24	86	31	112	50	180
400-200	400-200-160-B	38	137	49	176	83	299
550-250	550-250-200-B	56	202	71	256	100	360
550-300	550-300-250-B	95	342	110	396	160	549

The data specified in the table is applicable to 50 Pa total pressure, with commissioning box ALV with rear connection.

**) Lp10A = Sound pressure incl. A-filter with 4 dB room attenuation and 10 m² room absorption area.*

Technical description

Design

Rectangular supply air diffuser for installation in a wall. The air diffuser, which is easy to remove, is equipped with guide vane perforations.

Materials and surface treatment

The air diffuser face is made of sheet steel and is painted.

- Standard colour:
 - White semi-gloss, lustre 40, RAL 9003/NCS S 0500-N
- Alternative standard colours:
 - Silver gloss, lustre 80, RAL 9006
 - Grey aluminium gloss, lustre 80, RAL 9007
 - White semi-gloss, lustre 40, RAL 9010
 - Black semi-gloss, lustre 35, RAL 9005
 - Grey semi-gloss, lustre 30, RAL 7037
- Non-painted finish and other colours available on request

Accessories

Commissioning box

ALV

Made of sheet steel and contains a removable commissioning damper, fixed measurement tapping and air distribution baffle. Available with two different connection options: rear and side connection. Tightness class C on the housing according to SS-EN 12237 and VVS/AMA.

Cover plate

ALVT 1

For a fitted and aesthetic installation of the ALV commissioning box.

Planning

The ALV commissioning box is well-suited for installation in 1200 mm plasterboard walls (600 mm centre to centre) and 900 mm plasterboard walls (450 mm centre to centre).

Installation

Installation and dismantling can be seen from figure 1.

1. Prepare an opening in the wall according to the dimensions specified.
2. Place the commissioning box containing the damper insert, air distribution plate and air distribution baffle in the opening.
3. Apply sealing compound between the commissioning box and the mounting frame to prevent air leakage. Insert the mounting frame into the commissioning box and secure it with screws in the short sides to the commissioning box and to the wall structure.
4. Press the diffuser face into the mounting frame.



Commissioning

Commissioning should be carried out with the diffuser face mounted. The measuring tube and the damper adjustment cords are pulled out of the air diffuser through the perforation. A pressure gauge is connected to the measuring tube. The desired commissioning pressure can be calculated using the rated coefficient of performance (K-factor) of the air diffuser. The damper is set to the correct blade position, a commissioning knot is tied in the damper cords to indicate the damper position. Then the cords are locked against the locking screw in the air distribution baffle.

The K-factor is specified on the product's identification label, as well as in the relevant commissioning instructions at www.swegon.com.

Maintenance

The air diffuser can be cleaned, if necessary, using luke-warm water with dishwashing detergent added or by vacuum cleaning using a brush nozzle. The duct system can be accessed by dismantling the diffuser face, withdrawing the air distribution baffle, moving the air distribution plate to the side and turning the damper and withdrawing it from the inlet holder (see figure 1).

Environment

The Building Materials Declaration is available from www.swegon.com.

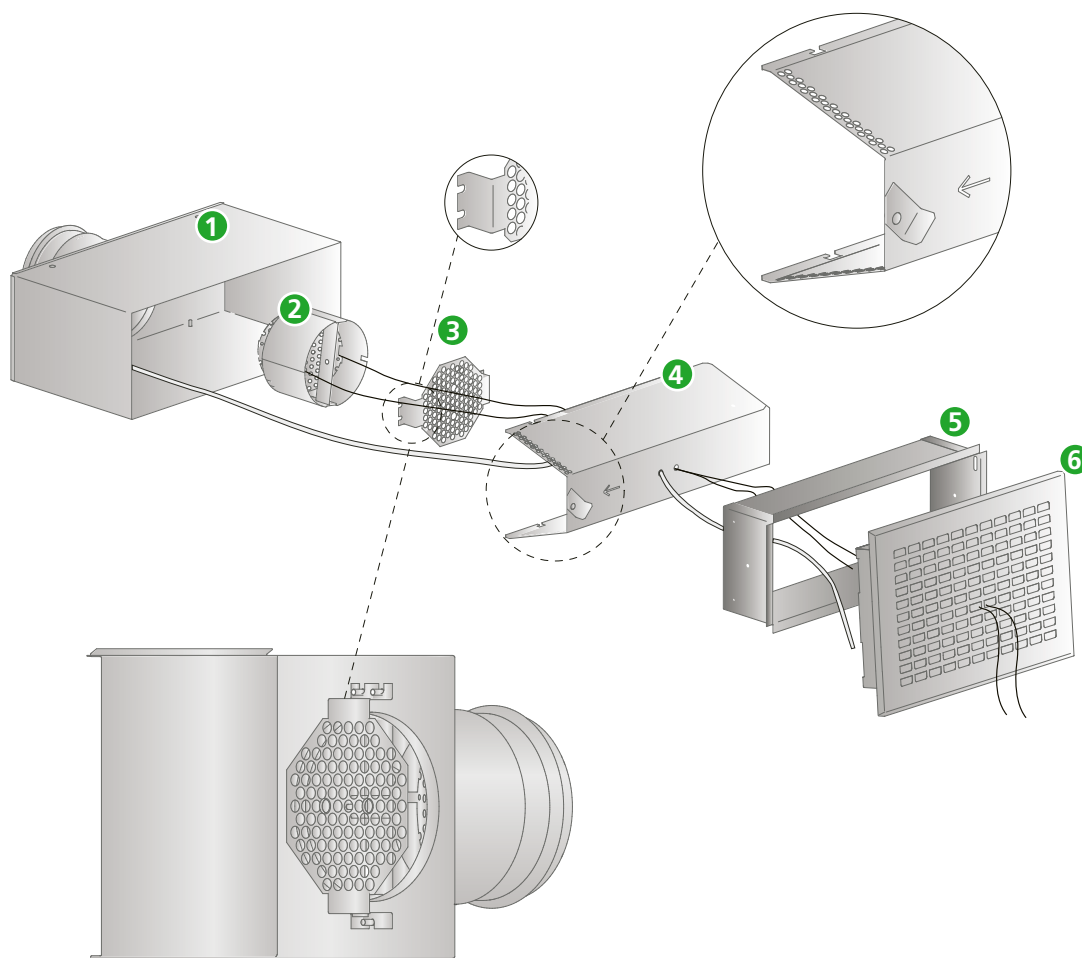

Figure 1. Installation.

1. Commissioning box.
2. Damper insert, bayonet catch.
3. Octagonal air distribution plate, enlarged image shows the locking device.
4. Air distribution baffle, enlarged image shows the locking device.
5. Mounting frame.
6. Diffuser face.

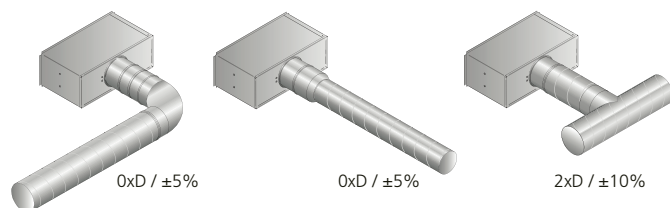

Figure 2. Installation options, applicable to all connections (B, K).

Sizing

- Sound levels dB(A) are applicable to rooms with an equivalent sound absorption area of 10 m².
- Sound attenuation (ΔL) below is shown in the octave band. Orifice attenuation is included in the values.
- The throw length $l_{0.2}$ is measured under isothermal discharge conditions.
- The diagrams illustrate data for LOCKZONE Wall mounted with its top edge 200 mm from the ceiling.
- The recommended max. permissible temperature below room temperature is 12 K.
- To calculate the air stream diffusion, air velocities in the occupied zone or sound levels in rooms with other dimensions, please refer to our calculation software available on www.swegon.com.

L_W = Sound power level

L_{p10A} = Sound pressure level dB (A)

K_{ok} = Correction for producing the L_W values in the octave band

$L_W = L_{p10A} + K_{OK}$ gives the frequency divided octave band

Sound data

LOCKZONE Wall + ALV – Supply air

Sound power level L_W (dB)

Table K_{OK}

Size	Mid-frequency (octave band) Hz							
	63	125	250	500	1000	2000	4000	8000
300-150	-1	7	5	-2	0	-5	-14	-22
400-150	-3	3	3	0	0	-4	-13	-20
400-200	-2	4	4	0	0	-5	-14	-19
550-250	-3	3	2	0	0	-6	-13	-19
550-300	-3	5	2	1	0	-7	-14	-20
Tol. ±	2	2	2	2	2	2	2	2

Sound attenuation ΔL (dB)

Table ΔL

Size	Mid-frequency (octave band) Hz							
	63	125	250	500	1000	2000	4000	8000
300-150	20	12	8	1	6	13	7	7
400-150	18	8	7	5	6	7	10	12
400-200	14	11	4	3	5	7	5	5
550-250	11	11	3	4	2	3	5	8
550-300	13	9	2	3	5	3	4	5
Tol. ±	2	2	2	2	2	2	2	2

Sizing diagram

Air flow – Pressure drop – Sound level – Throw length

- The throw length $l_{0,2}$ is measured under isothermal discharge conditions.
- The diagrams illustrate data for LOCKZONE Wall mounted with its top edge 200 mm from the ceiling.
- The recommended max. permissible temperature below room temperature is 12 K.
- To calculate the air stream diffusion, air velocities in the occupied zone or sound levels in rooms with other dimensions, please refer to our calculation software available on www.swegon.com.
- The diagrams should not be used for commissioning.
- ∇ = Min. airflow required for obtaining sufficient commissioning pressure
- The dB(A) values apply to rooms with normal acoustic absorption, 4 dB room attenuation/10 m² equivalent room absorption area.
- The dB(C) value is normally 6-9 dB higher than the dB(A) value.

Supply air – Air diffuser with commissioning box

LOCKZONE Wall 300-150 + ALV 300-150-100-B/K

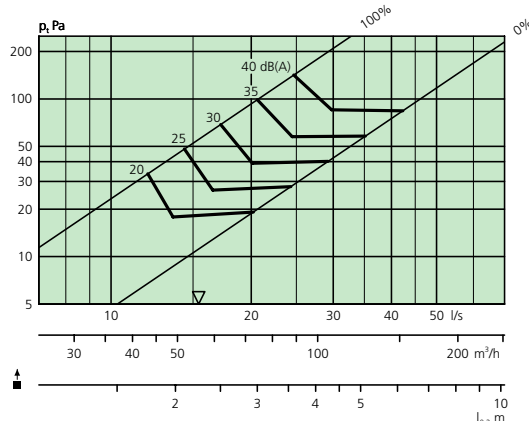

LOCKZONE Wall 550-250 + ALV 550-250-200-B/K

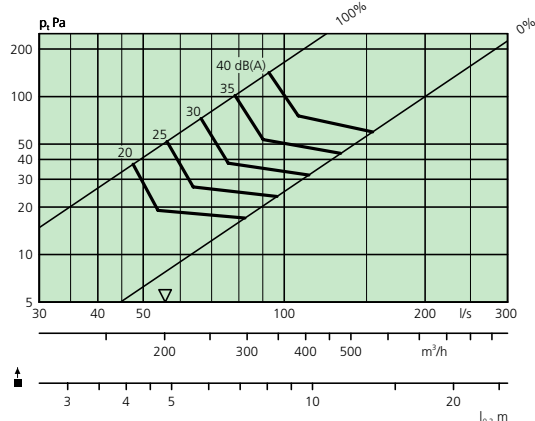

LOCKZONE Wall 400-150 + ALV 400-150-125-B/K

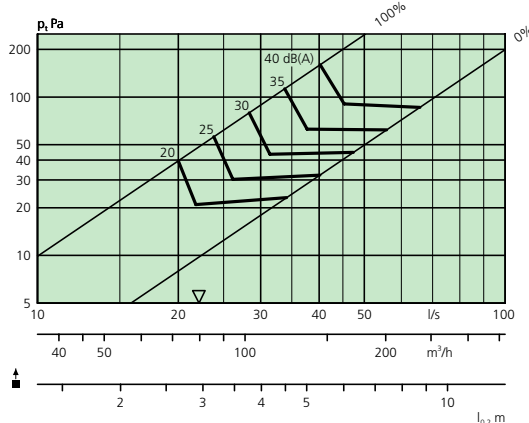

LOCKZONE Wall 550-300 + ALV 550-300-250-B/K

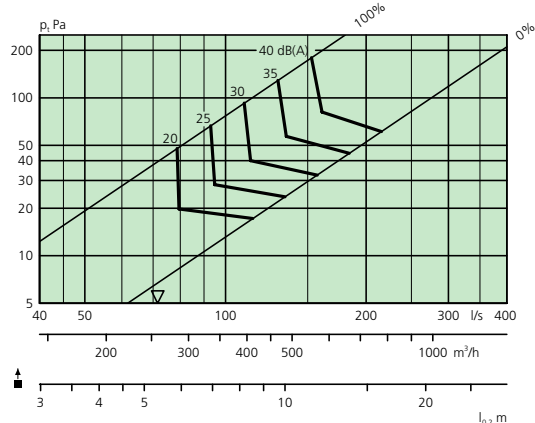

LOCKZONE Wall 400-200 + ALV 400-200-160-B/K

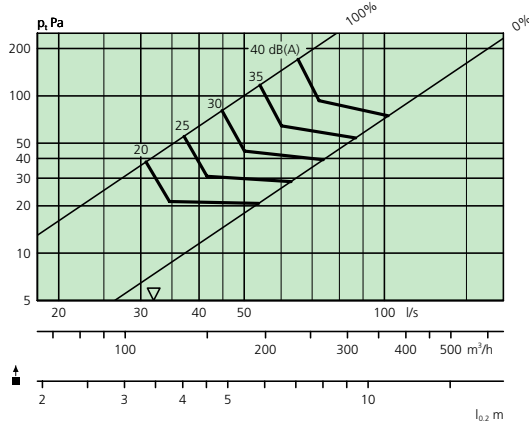

Dimensions and weight

LOCKZONE Wall and commissioning box ALV - rear connection

Size	Dimensions (mm)							Weight, diffuser (kg)	Weight, diffuser incl. ALV (kg)
	A	B	ØD	F	G	K	I x J		
300-150	330	180	99	295-375	225-305	70	305 x 155	0.9	3.3
400-150	430	180	124	295-375	225-305	70	405 x 155	1.2	4.2
400-200	430	230	159	315-395	225-305	90	405 x 205	1.4	4.9
550-250	580	280	199	360-440	251-331	110	555 x 255	2.1	7.1
550-300	580	330	249	385-465	251-331	134	555 x 305	2.3	8.2

Size of opening = I x J

CL = Centre line

LOCKZONE Wall and commissioning box ALV - short side connection

Size	Dimensions (mm)								Weight, diffuser (kg)	Weight, diffuser incl. ALV (kg)
	A	B	ØD	G2	K	L	M	I x J		
300-150	330	180	99	270-350	77	145-225	195-275	305 x 155	0.9	3.5
400-150	430	180	124	331-411	77	180-260	240-320	405 x 155	1.2	4.7
400-200	430	230	159	331-411	95	145-225	225-305	405 x 205	1.4	5.4
550-250	580	280	199	371-451	114	145-225	245-325	555 x 255	2.1	8.0
550-300	580	330	249	425-505	138	145-225	275-355	555 x 305	2.3	9.4

Size of opening = I x J

CL = Centre line

ALVT 1

Size	Dimensions (mm)		
	A	B	N
300-150	330	180	230
400-150	430	180	230
400-200	430	230	230
550-250	580	280	255
550-300	580	330	255

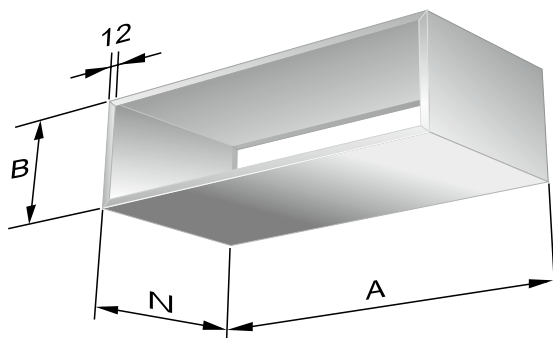

Figure 3. Cover plate ALVT 1.

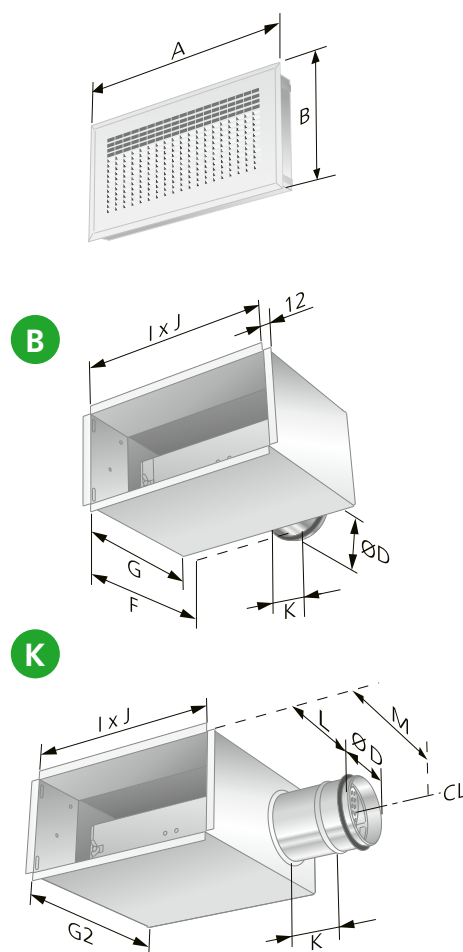

Figure 4. Dimensions, LOCKZONE Wall and commissioning box ALV.

B = Rear connection.

K = Connection on short side.

CL = Centre line.

Specification

Product

Rectangular perforated wall diffuser	LOCKZONE W	c	aaa	-bbb
Version:				
Nominal width in mm: 300, 400, 550				
Nominal height in mm: 150, 200, 250, 300				

Standard range	
Size:	300-150
	400-150
	400-200
	550-250
	550-300

Accessories

ALV

Commissioning box	ALV	e	aaa-bbb-ccc	-d
Version				
For sizes:	ALV			
300-150	300-150-100			
400-150	400-150-125			
400-200	400-200-160			
550-250	550-250-200			
550-300	550-300-250			
Connection options:				
B = Rear				
K = Short side				

Cover plate

Cover plate	ALVT 1	e	aaa-bbb	-d
Version:				
Size:	300-150			
	400-150			
	400-200			
	550-250			
	550-300			
Connection options:				
B = Rear				
K = Short side				

Specification text

Swegon's complete rectangular perforated type LOCKZONE Wall air diffuser for wall mounting with ALV commissioning box and the following functions:

- Guide vane perforations.
- Powder-painted and baked white finish, RAL 9003/NCS S 0500-N.
- Cleanable ALV commissioning box with removable commissioning damper, measuring method with low systematic error.

Size:	LOCKZONE Wc aaa-bbb with ALVe aaa-bbb-ccc-d	xx pcs
Accessories:		
Cover plate:	ALVT 1e aaa-bbb-d	xx pcs