

SKD Q

Square adjustable ceiling swirl diffuser for supply- or extract air



QUICK FACTS

- Swirl diffuser in a square design
- Supports high air flows with low sound power levels
- High flexibility with the adjustable air deflectors
- Plenum box with horizontal or vertical duct connection
- Available in a design in accordance with VDI 6022 hygiene standards
- Standard colour Signal White RAL 9003

Size	L _{WA} = 25 dB			L _{WA} = 30 dB			L _{WA} = 35 dB			L _{WA} = 40 dB		
	V (m ³ /h)	Δ p (Pa)	L _{0.2} (m)	V (m ³ /h)	Δ p (Pa)	L _{0.2} (m)	V (m ³ /h)	Δ p (Pa)	L _{0.2} (m)	V (m ³ /h)	Δ p (Pa)	L _{0.2} (m)
300	105	15	2.1	118	20	2.4	145	30	2.9	181	46	3.7
400	245	13	3.3	290	18	3.9	351	26	4.8	418	38	5.8
500	382	12	4.2	457	18	5.1	540	25	6	646	36	7.1
600, 620, 625	473	10	3.8	583	16	4.5	688	22	5.3	812	31	6.2
800	725	11	3.6	932	18	4.3	1140	28	5.2	1362	41	6.1

Content

Technical description	3
Design	3
Functionality	3
Material and surface treatment	3
Adaptation	3
Installation	3
Accessories	3
Plenum box.....	3
Technical data.....	4
Sizing diagrams.....	4
Extract air	4
Dimensions.....	5
Specification.....	6
Specification text.....	6

Technical description

Design

The SKD Q is a square ceiling swirl diffuser equipped with radially arranged air deflectors for supply or extract air.

Its design ensures high air flow capacity while maintaining low sound power levels. The rotatable air deflectors allow flexible adjustment of the distribution pattern, which can be set via an electric motor or thermal slat.

Functionality

The adjustable air deflectors are mounted in slat holders, allowing the distribution pattern to be adjusted as needed. By individually adjusting the air deflectors, the distribution pattern can be adapted to the room's architectural features, enabling air flow to effectively navigate around nearby elements such as columns, cabinets, or wall protrusions.

Material and surface treatment

Diffuser face

- Made of galvanised steel.
- Standard colour:
 - RAL 9003, signal white, gloss 70
- Alternative standard colours:
 - RAL 9010, pure white, gloss 70
 - RAL 9006, white aluminium, gloss 70
 - RAL 9005, jet black, gloss 70
 - RAL 7035, light grey, gloss 70

Air deflectors

- Made of extruded aluminium.
- Standard colour:
 - RAL 9005, jet black

Slat holder

- Made of stainless steel.
- Standard colour:
 - RAL 9005, jet black

Adaptation

- Other colours available on request.
- Available in stainless steel or aluminium on request.
- Available in a version certified according to VDI 6022.

Installation

The diffuser face is mounted using a central screw fastening (size 800 with additional screws in the edge region).

Accessories

Plenum box

- Horizontal or vertical duct connection.
- Perforated commissioning damper in the spigot, actuated by pull cable.
- Made of galvanised steel.



SKD Q with plenum box, horizontal duct connection.

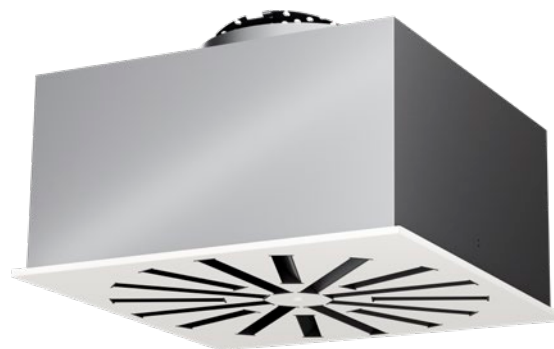

SKD Q with plenum box, vertical duct connection.

Technical data

Sizing diagrams

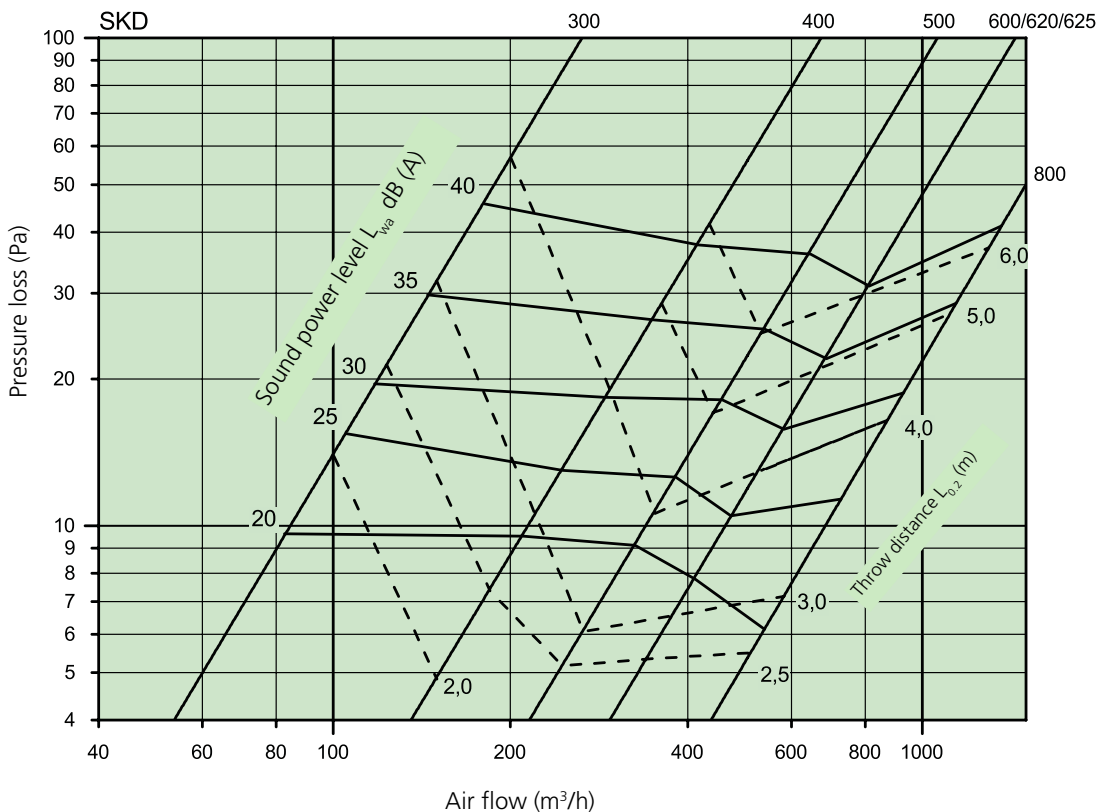

Extract air

Data for size 600, including plenum box (horizontal duct connection).

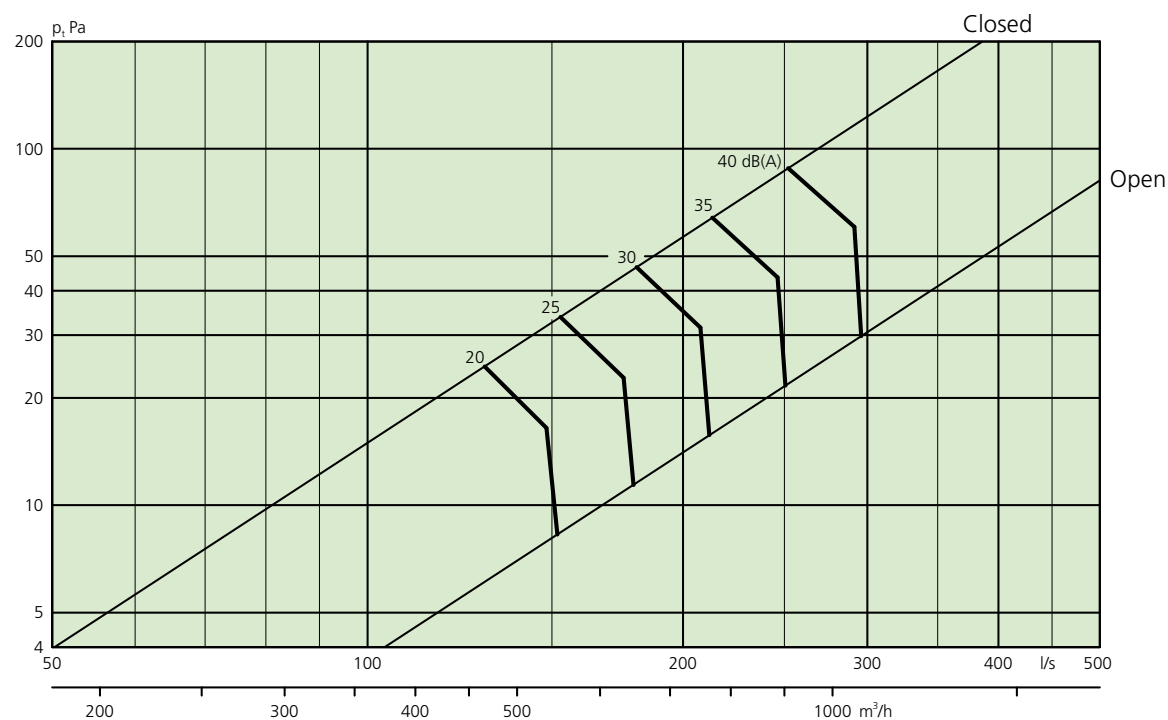

Dimensions

Size	A (mm)	B (mm)	Hh (mm)	Hv (mm)	Ød (mm)
300	300	270	205	200	123
400	400	370	280	200	198
500	500	470	330	250	248
600, 620, 625	600, 620, 625	570	395	300	313
800	800	770	480	400	398

The specified measurements refer to the external dimensions (mm). These can be adjusted within functional limits to meet specific requirements.

Hh = height for plenum box with horizontal duct connection.

Hv = height for plenum box with vertical duct connection.

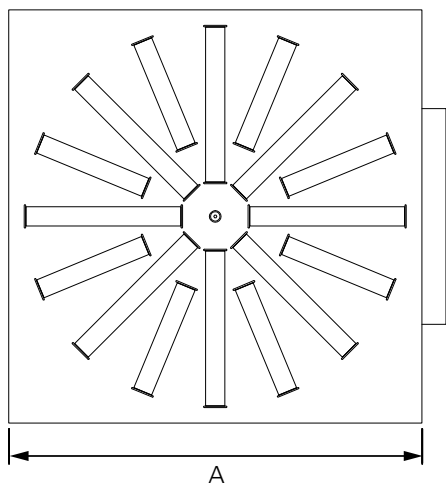

Figure 1. SKD Q, dimensions.

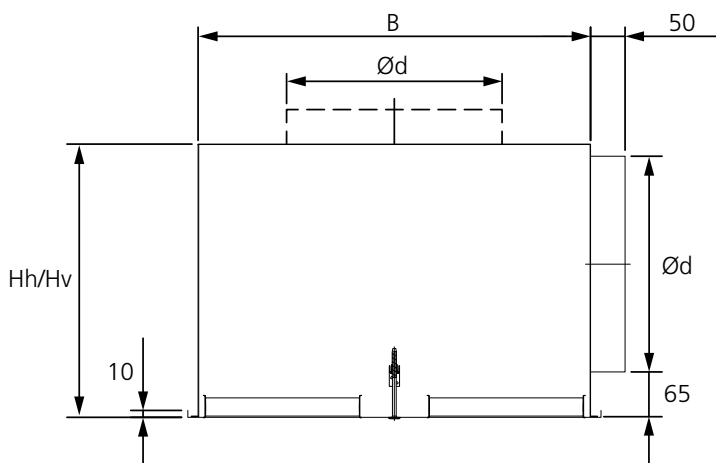
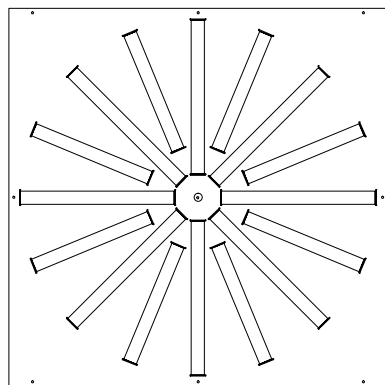
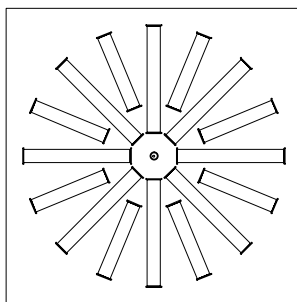

Figure 2. Plenum box, dimensions.



Size 800.



Size 620, 625.

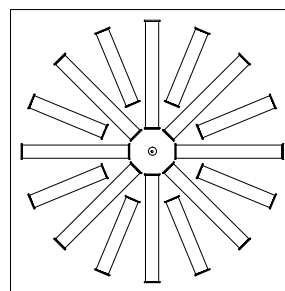

Size 600.

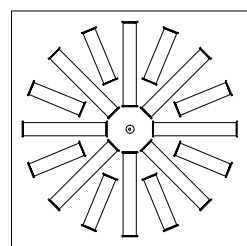

Size 500.

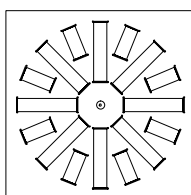

Size 400.

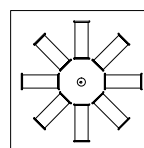

Size 300.

Figure 3. SKD Q, diffuser face and sizes.

Specification

For ordering, contact your local Swegon sales office.

Specification text

SKD Q square ceiling swirl diffuser with adjustable air deflectors with the following features:

- Diffuser face with radially inserted air deflectors.
- Available in a supply air or extract air variant.
- Diffuser face made of galvanised steel, standard colour white (RAL 9003).
- Air deflectors made of extruded aluminium profiles, standard colour black.
- Slat holders made of stainless steel, standard colour black.