

# CLV

Installation – Commissioning – Maintenance

21-08-2025  
Art. 942428100

## Installation

### General

Check the product before and after installation. Damaged or faulty products must not be installed. Report faults immediately to the nearest Swegon office.

### Checks

Product marking can be found on the silencer.

### Suspension

The product's connection spigots are intended for connection to ducts only.

Screws or blind rivets are attached to the permanent 25 mm sheet-metal edge which is located inside the connection spigot. See Figure 1.

The product should be fastened using approved suspension devices corresponding to load-bearing capacity R

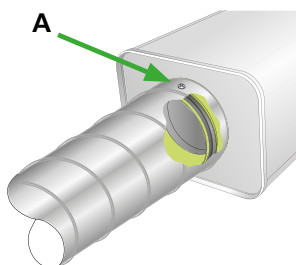

Figure 1. Fasten the connection duct to the turned up sheet-metal edge that is fixed in place inside the connection spigot with a screw or blind rivet (a).

## Commissioning

The silencer does require commissioning.

## Maintenance

The product is maintenance-free under normal operating conditions.

Normal operating temperature (continuous) is between -30° and 50°C.

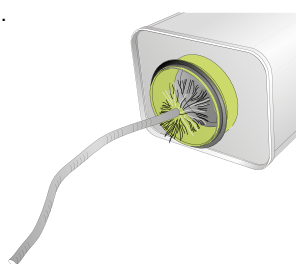

Figure 2. Cleaning with plastic brush

## Dimensions

Dimensions are specified on the product label as connection dimension and length.

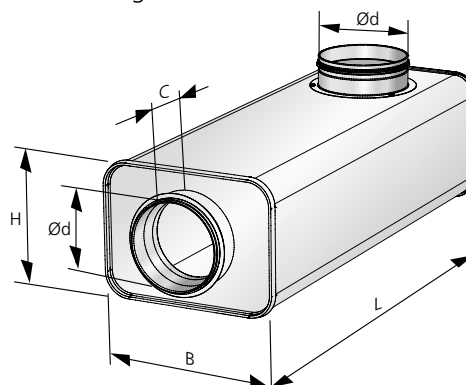

Figure 3. CLV – dimensional drawing

| Size | B<br>mm | H<br>mm | L<br>mm | C<br>mm | Ød<br>mm | E<br>mm |
|------|---------|---------|---------|---------|----------|---------|
| 100  | 208     | 152     | 603     | 34      | 99       | 100     |
| 100  | 208     | 152     | 1003    | 34      | 99       | 100     |
| 125  | 236     | 177     | 603     | 34      | 124      | 112,5   |
| 125  | 236     | 177     | 1003    | 34      | 124      | 112,5   |
| 160  | 274     | 212     | 603     | 34      | 159      | 130     |
| 160  | 274     | 212     | 1003    | 34      | 159      | 130     |
| 200  | 321     | 252     | 603     | 34      | 199      | 150     |
| 200  | 321     | 252     | 1003    | 34      | 199      | 150     |

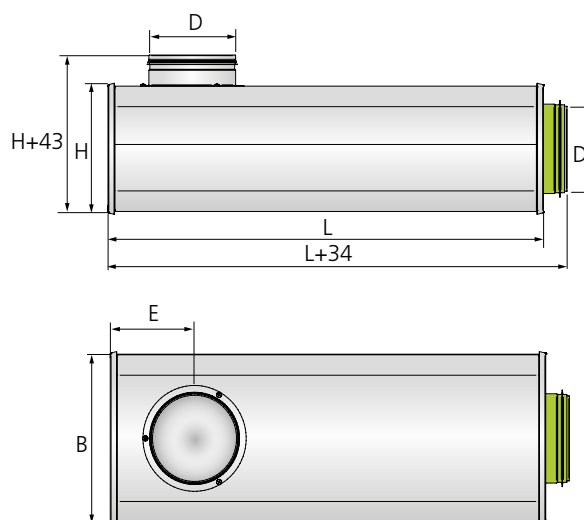

Figure 4. CLV – dimensional drawing (side view)