

## Installation Detail

If your proposed installation details differ from that shown here, please discuss this with the authority having jurisdiction, referencing this documentation.

Deviation from this drawing requires approval of the relevant authority.

Connecting ductwork omitted for clarity. Ductwork must be independently supported. There must be an appropriate break-away joint between the damper and the connecting ductwork on both sides of the installation.

A minimum of 200mm between fire dampers installed in separate ducts and 75mm between fire damper and construction elements/edges needs to be observed unless otherwise specified in the drawing.



SCAN ME

Please refer to the DoP for latest classifications for CE/UKCA compliance and the Installation, Operation and Maintenance Guide

K	ECN2324	MJB	06-02-24
J	ECN2227	MJB	29/04/22
I	ECN5134	MJB	05-02-21
H	ECN1959	MJB	26-11-19
G	EC1839	RTC	13/04/18
F	EC1830	RTC	20/03/18
E	EC1770	MJB	20-02-18
Rev:	Comments:	By:	Date:

Drawn By: S.Wehrle Date: 15/07/2010

Checked By: S. Gore Date: 06/02/2024

Approved By: M. Kimberley Date: 06/02/2024

Description:

**VERTICAL APPLICATION**  
**SMOKE SHIELD + DWFX-F S & A**  
**+ ABLATIVE BATT**

Damper Size Range (mm)  
200 x 200 to 1000 x 1000

Reference No:	Sheet	Rev
AAF10712	1 of 1	K

### VERTICAL BLADES;

Damper can be installed with the blades in the vertical orientation with actuator mounted at either the top or bottom. For cleat locations of motors mounted on top refer to drawing AA-SS-2005 and for motors mounted on the bottom refer to drawing AA-SS-2006.

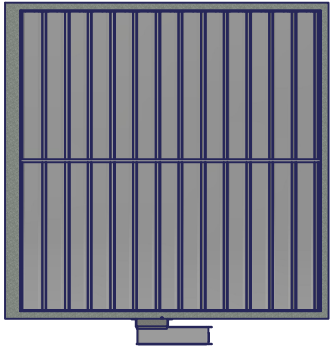

For ref. up to 2400mm Rockwell ablative batt refer to dimensions on section A-A

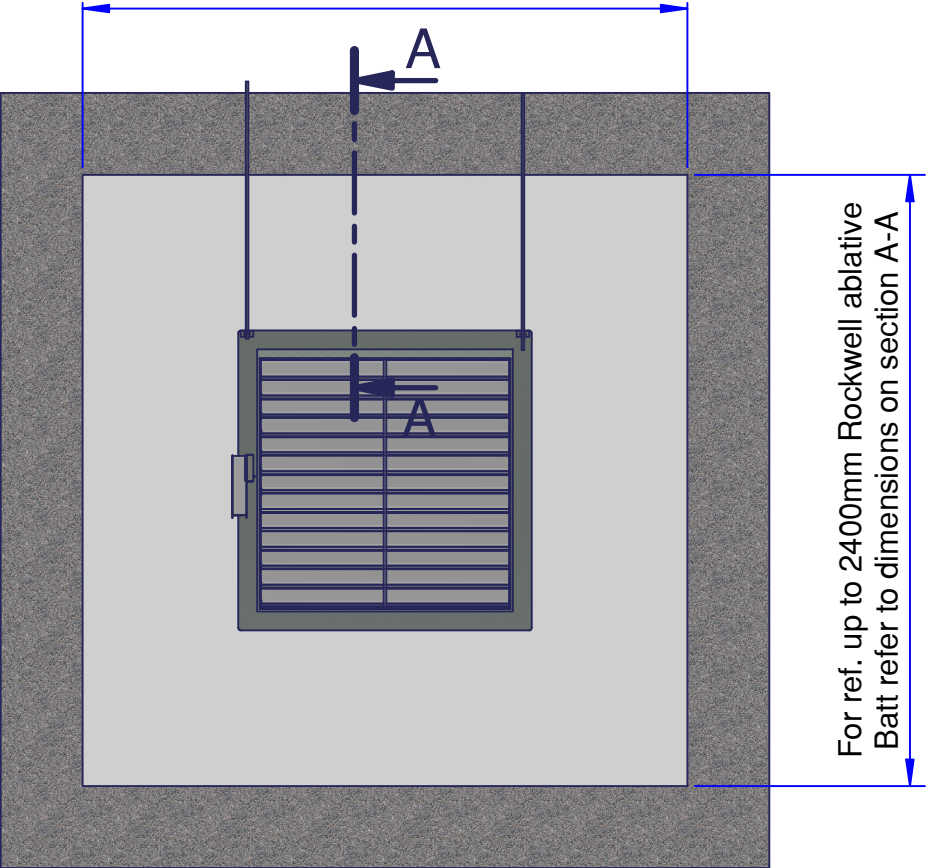

For ref. up to 2400mm Rockwell ablative batt refer to dimensions on section A-A

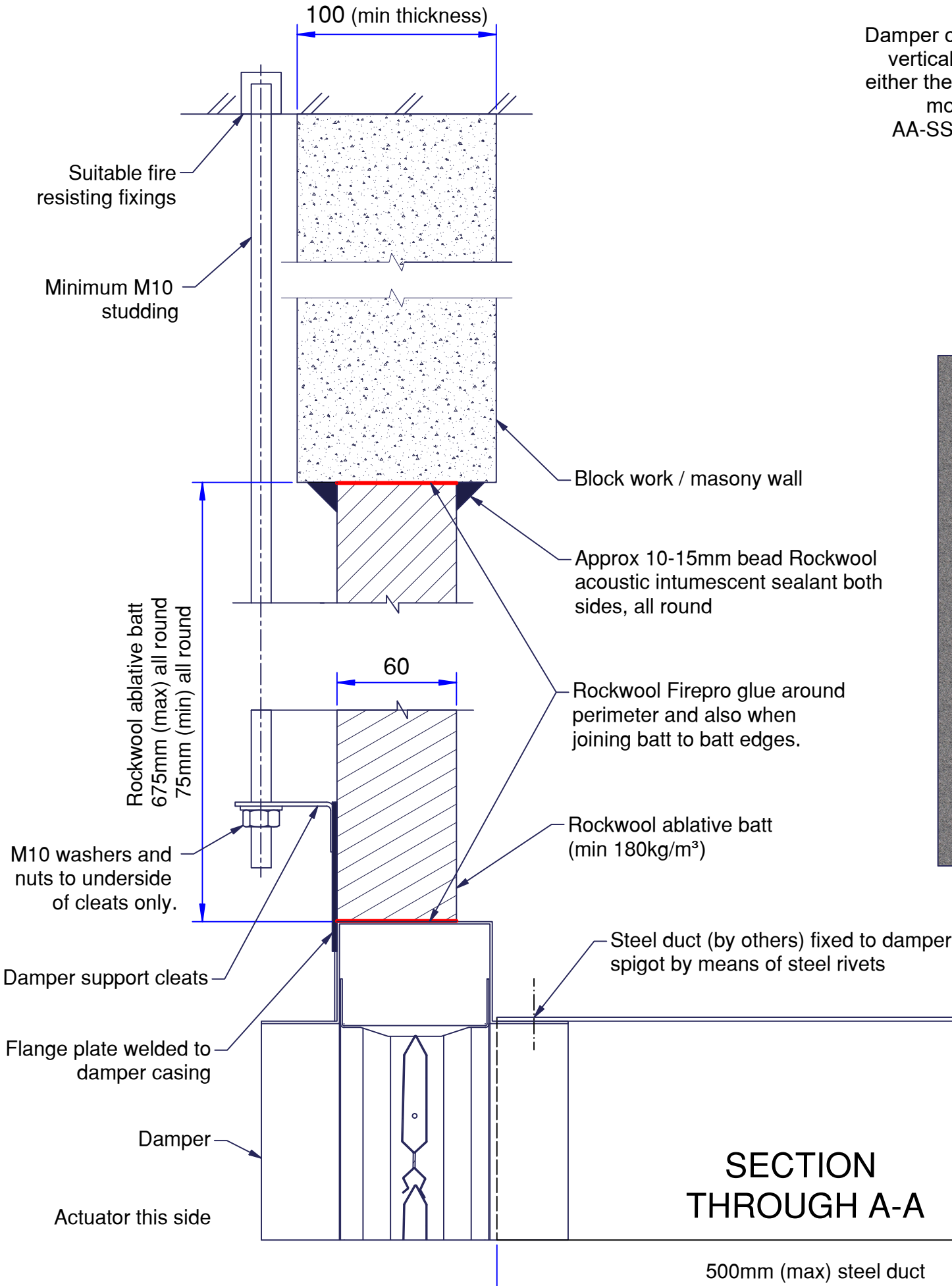

### SECTION THROUGH A-A

Please note that this stub duct section constitutes part of the damper installation and therefore an appropriate breakaway joint should be positioned where the stub duct meets the connecting ductwork.

