

12.5mm gypsum fire boards type F (EN520) both sides.

min 75mm wall thickness

min 40 mm drywall screws fixing installation flange to wall into UDT52 section. 4 screws $\leq \varnothing 200\text{mm}$ and 8 screws for $> \varnothing 200\text{mm}$.

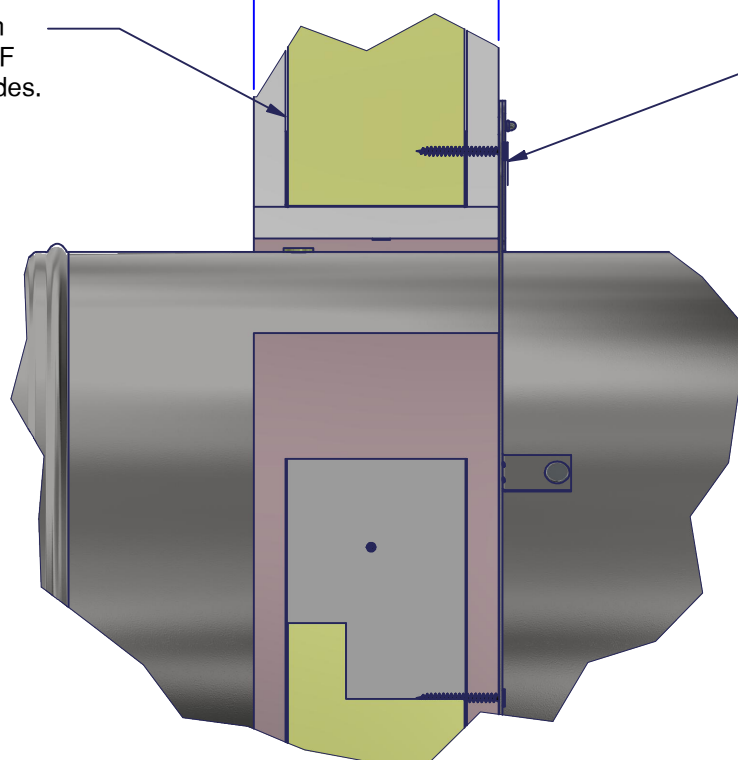

VIEW B

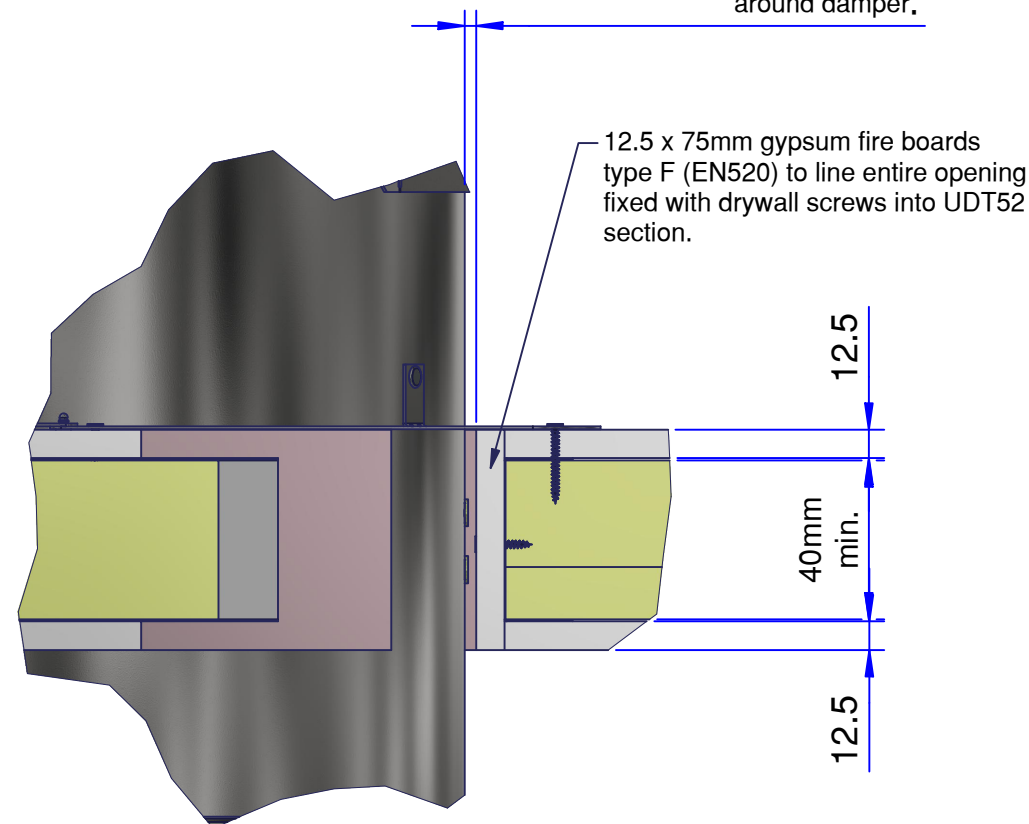
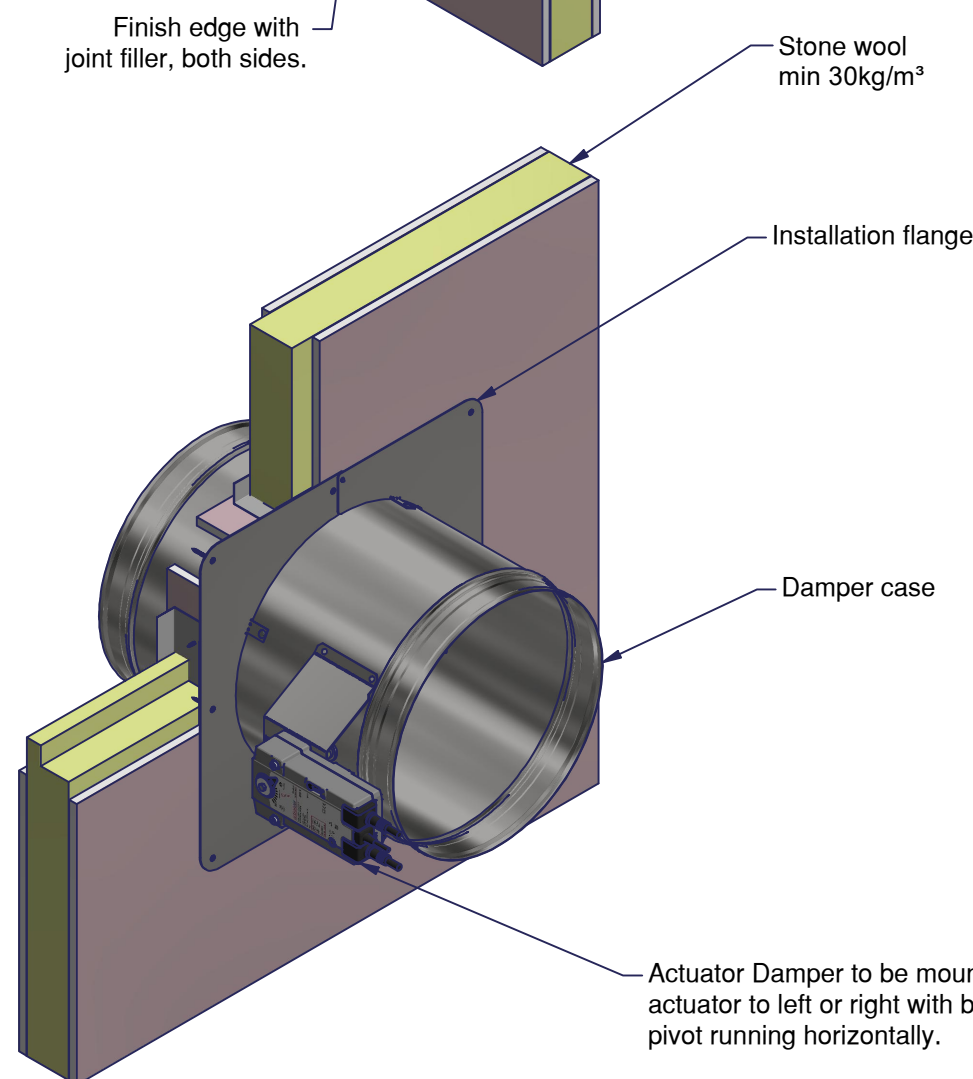
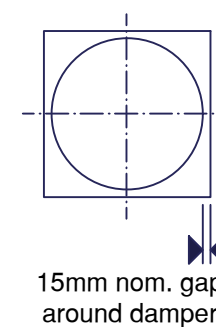

VIEW A

Installation Detail

If your proposed installation details differ from that shown here, please discuss this with the authority having jurisdiction, referencing this documentation.

Deviation from this drawing requires approval of the relevant authority.

Connecting ductwork omitted for clarity. Ductwork must be independently supported. There must be an appropriate break-away joint between the damper and the connecting ductwork on both sides of the installation.

A minimum of 200mm between fire dampers installed in separate ducts and 75mm between fire damper and construction elements/edges needs to be observed unless otherwise specified in the drawing.



SCAN ME

Please refer to the DoP for latest classifications for CE/UKCA compliance and the Installation, Operation and Maintenance Guide

A	Initial Issue	JPM	12/07/22
Rev:	Comments:	By:	Date:
Drawn By:	J. Mount	Date:	16/06/2022
Checked By:	M.Kimberley	Date:	12/07/2022
Approved By:	S.Gore	Date:	12/07/2022

Description:
VERTICAL APPLICATION
CSS - IN PLASTERBOARD WALL

Damper Size Range (mm)
 $\varnothing 100\text{mm.} - \varnothing 355\text{mm.}$

Reference No:	Sheet	Rev
AAF13413	1 of 1	A

