



## CASA JAZZ

Design cooker hood for connection to the ventilation unit or separate installation



**Swegon** 

# CASA Jazz

Design cooker hood CASA Jazz fits perfectly in modern kitchens. Together with your home's ventilation system, it guarantees fresh indoor air and energy-efficient, balanced ventilation in your home.

Jazz can be connected directly to R2/R3 Genius ventilation unit or mounted below the cabinet in apartment blocks or family homes. The smooth surfaces and washproof metal grease filters are easy to keep clean. The lighting in the hood is made up of maintenance-free LED lights with adjustable brightness. The cooker hood with voltage protection (24 V) is equipped with a main transformer – its power consumption is therefore low and the hood is always safe for the user. All electrical connections are located above the hood and are therefore quick and easy to connect during the installation phase. The hood is also equipped with a function for up to 10 hours of summer cooling, which can be easily selected from the hood.

## Control of ventilation units

A Genius ventilation unit can be controlled from the Jazz cooker hood (away/home/boost). Jazz is installed under ventilation unit R2 (M-model) or R3 or installed separately between kitchen cabinets. The ventilation unit automatically compensates for the air removed via the cooker hood, preventing under-pressure in your home when cooking. The cooker hood has a high cooking odour catching capacity and works effectively even with low air volumes of exhaust, which provides good compensation. It is possible to control an older AC ventilation unit using the ITFC transformer available as an accessory.

## Control of roof fan

The Jazz cooker hood can be used to directly control a modern EC roof fan. Older AC-operated roof fans can be controlled using the ITFC transformer available as an accessory.

## Controlling the hood's fan unit/ house fan

The cooker hood can be used to directly control the very quiet Twist fan unit (TTEC). Twist can be used to replace the roof fans in small houses.

## Safera Safety stove guard

The Jazz cooker hood can be equipped with the Safera Safety stove guard. The stove guard helps to protect against the usual kitchen accidents by preventing the cooker from being left unsupervised while in use and cutting the power if you forget to turn off the stove. On the Safera models of Jazz, the stove guard is preinstalled in the cooker hood and mounted under the cooker hood. In addition to this, a power control unit that is approved for use (3-phase or 1-phase) is needed. Swegon also recommends installing a water leakage monitor (SA1).

- 1** Excellent cooking odour catching capability: 77 %, 30 l/s/108 m<sup>3</sup>/h
- 2** Capacitive touch screen
- 3** The Safera safe operation feature is available.
- 4** Maintenance-free LED lighting, adjustable brightness.
- 5** Installed below R2/R3 ventilation unit or separately
- 6** White and stainless steel
- 7** Available width 600 mm



Swegon CASA\*





# Technical data

## Dimensions

### Jazz Genius

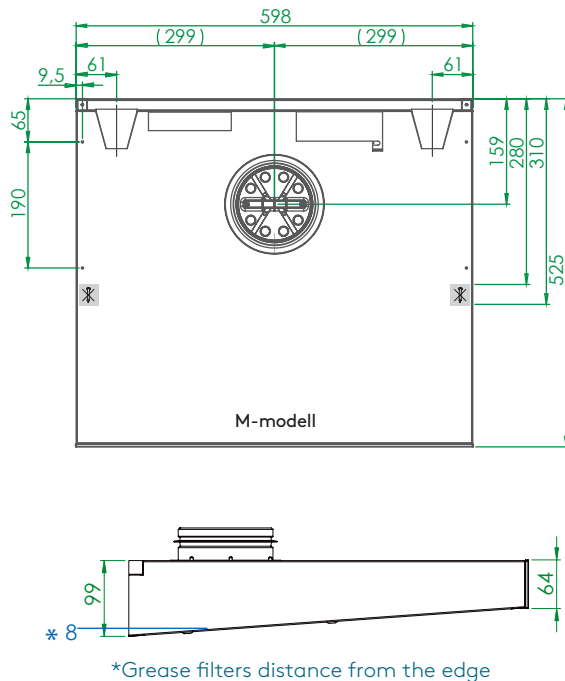

### Basic ventilation

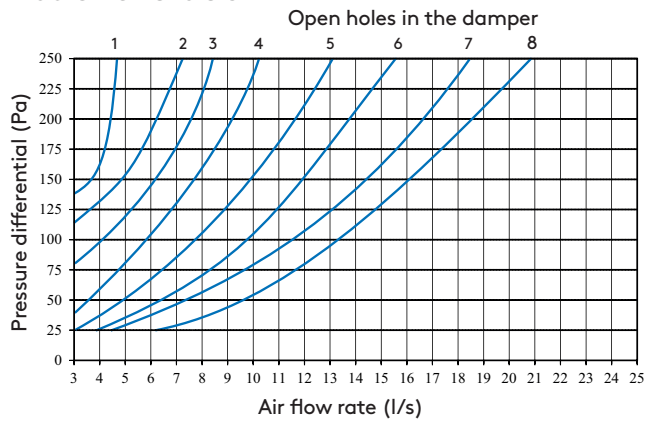

### Boosted ventilation

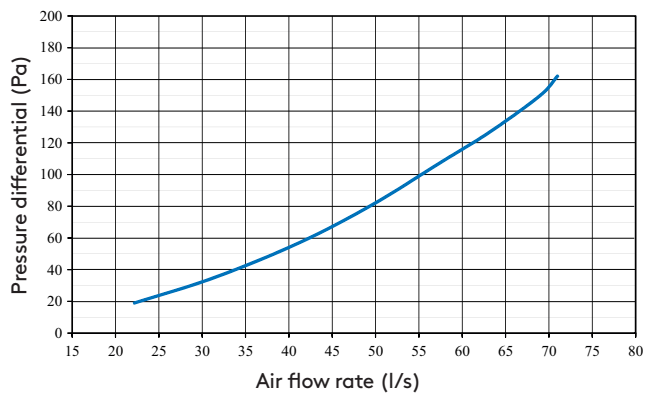

### Cooking odour arresting capability

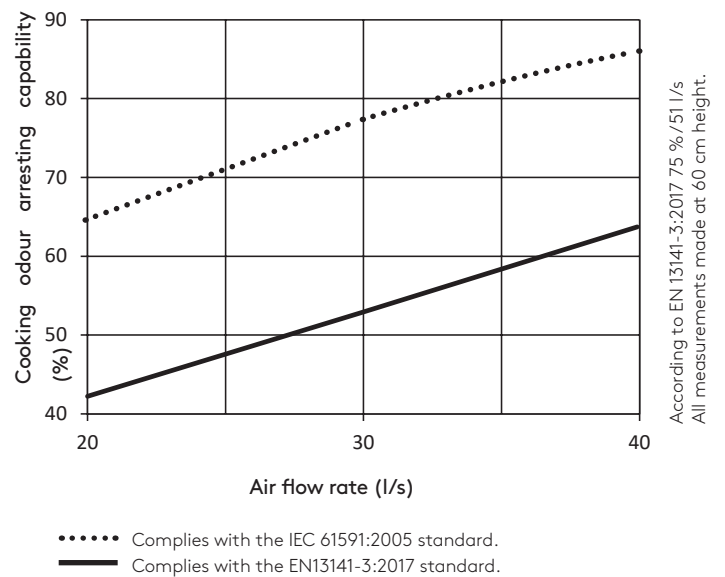



# Colours

**White**



**Stainless steel**



# Models

Compatible with	CASA JAZZ GENIUS	
	CASA ventilation unit	●
	Centralised ventilation systems	—
	Centralised ventilation systems (Free Flow)	—
	EC external fan	●
	AC external fan	○*
	Width mm	600
	Height of front panel mm	64
	Depth mm	525
	Electrical connection	Ventilation unit contact / plug
	Colour/material	White / stainless steel
	Lighting	LED (4000K)
	Control panel	Capacitive touch screen
	Grease filter	2 stainless steel filters
	Damper	●
	Electronic timer	●
	Fan speed	3 speeds
	Smoke extractor	—
	Silencer box	—
	Duct enclosure	—
	Safera safety technology	○ also integrated with an extinguisher
	Installation method	Between kitchen cabinets / below R3
	Safety voltage	●
	Provision to control the damper with a separate switch	●
	Indicating signal for the damper position	●

● Standard ○ Possible — Not possible

\* ILVA transformer as accessory (ITFC)

## Cooker hood CASA Jazz, product codes

		Code	Product
PJV6M(S)*	Jazz Genius, white 600 mm, duct connection in the middle (R2)	632039	Safera power control unit 3-phase FI model
PJR6M (S)*	Jazz Genius, stainless steel 600 mm, duct connection in the middle (R2)	632037	Safera power control unit 1-phase FI model
ITFC	Transformer unit for AC control	632040	Safera power control unit 3-phase perilex SE model
CHR	Auxiliary relay 230 V for controlling actuators / Safera alarm signal	632038	Safera power control unit 1-phase 25A SE/NO model
		SA1	Safera water leakage monitor
		Power 24 V 20 W	Power supply SET/actuator

\* Product code without letter S = cooker hood without stove guard  
Product code ending with letter S = cooker hood with stove guard

Feel good **inside**

